

Survey Made for James Hilderburn

220

No 21

Aug 10<sup>th</sup> 1885

Beginning at Quarter post on North boundary of Sec 2. T 30 S R. 7 W.  
 Var 19° E

30-7

Thence

South

18.44 ch Set post No 1

Thence

S 89° 40' E.

20.00 ch Set post No 2

Thence

South

36.87 ch Set post No 3 from which  
 Pine 4 in dia bears N 59° E 14 ft

" 6 " " " " 35° W. 24 "

Thence

N 89° 40' W.

40.00 ch Set post No 4 - from which  
 Cedar 5 in dia bears N 78 1/2° W. 23 ft

" 4 " " " " 32 1/2° E. 30 "

W. J. Briggs Co Sur

No 22

Survey Made for John Sedot.

T. 30. S. R. 3. W.

Oct 30<sup>th</sup> 1888

30-7

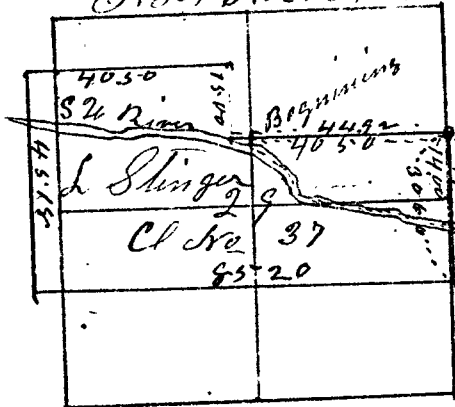

Beginning at a point on Right Bank of S.W. River one chain from center of River at which the calculation is to be made from

Thence - Var 19° E

East

40.50 to the N.E. corner of claim

Thence

South

14.00 to 1/43 post bet sec 28 & 29

19.20 to center of River

Thence around of R bank of River one chain from center of

N 68 1/2° W. 3.00 Lts N 72° W. 250 Lts N 71 1/4° W. 950 Lts

N 74° W. 1450 Lts N 66° W. 368 Lts N 14° W. 475 Lts N 51° W.

314 Lts N 74° W. 525 Lts to place of beginning

Cont 43.88 ac

W. J. Briggs Co Sur