

No 21 Survey for Lewis Ash + others T30S R58E

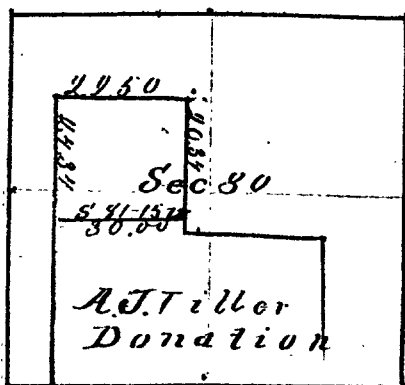

From the North West Corner of the A.J. Tiller
Donation Claim No 63 in Town 30 S of Range 58 E
South 24.34 chains on West boundary by 1530 E
Set Stake from which a
W Oak 12 bears N 84°-45' 58" 102 links
" " 8 " N 26°-45' E 152 "
Thence N 81°-15' E 29.92 Intersect East
boundary of Claim No 63 at a point
20.34 chains South of the N E Corner of
said Donation Claim No 63
From which a B Oak 16 N 55°-45' 58" 83 links
" " 12 S 47°-30' 58" 62 "

Surveyed May 23rd 1887

W. B. Britt and Lewis Ash were claimers
W. E. Britt

Clk. Sur.

By order of the County Court of Douglas
County Oregon Dated April 7th
A. D. 1887 Survey a County Road
from Looking Glass to Lewis Gate
Triller's notes of which are on file in
Clk Clerk's office

W. E. Britt
Clk. Sur.