

Survey for John McBea Sec 16 (T 28 S R 65 W)

No. 18

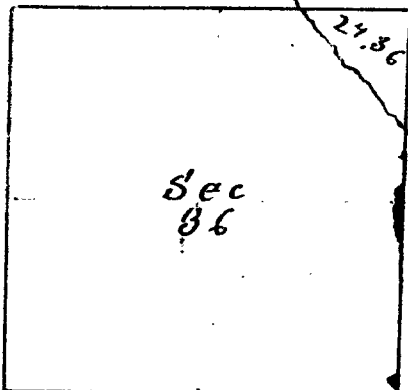

From the Corner to Sections 9-10-15+16
South 21.56 chains Right Bank South
Umpqua River

From the above mentioned corner to Sec 9-10-15+16
West 22.93 chains to Right Bank South
Umpqua River From which meander the
Right Bank of said Umpqua River
as follows viz

| | |
|-----------|-------------|
| S 62-30 E | 1.50 chains |
| S 60-00 E | 6.85 " |
| S 41-45 E | 11.30 " |
| S 53-30 E | 8.77 " |
| S 54-00 E | 2.67 " |
| S 42-00 E | 2.05 " |
| S 43-30 E | 3.42 " |

To line between Sections 15+16

Containing 24.36 acres (Mag. Va. 15-30 E)

Surveyed April 13th 1887

James C Park and
Cornelius W Beckwith sworn Chainmen
J. E. Pruitt
C. S. M.