

## No 8 Survey of Lands for James Chadwick

Being part of Sections 31 & 32 in  
Town 25 S of Range 5 W. 4th Mer.  
Surveyed Sept. 15<sup>th</sup> 1886  
William Rees and  
James Chadwick sworn  
Chamman

D. E. Brito  
C. Sur.

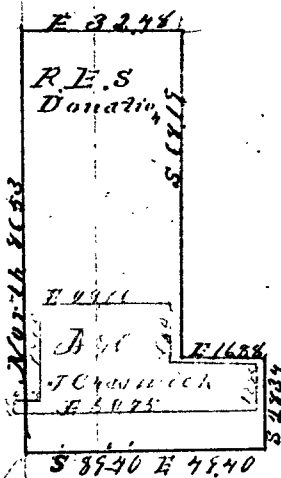

From a point Thirty Five Rods Fifteen Feet and  
Six Inches (8.99 chains) north and Ten Chains  
West of the Quarter Section Corner between  
Sections Thirty One (31) and Thirty Two (32)  
Town Twenty Five S. Range Five W. 4th Mer.  
From which a B Oak 16 dia bears S 50°-30 E 81 lin  
Pir 10 " " S 50-30 or 21.

East on South boundary of premises of J Chadwick  
50.75 chains (with neg Va. at 19°-50 E)

Thence north 12.90 chains

" West 17.50 "

" North 6.50 "

" West 29.00 "

" South 19.00 "

" West 4.25 "

" South 0.40 " to the place of

beginning containing 80 acres

Surveyed according to description of

Premises given by Decree of Court

to establish East and West 1/4 Sec Five

across section 32 T 25 S. R. 5 W.