

Geo. Shambrook April 5. 86.

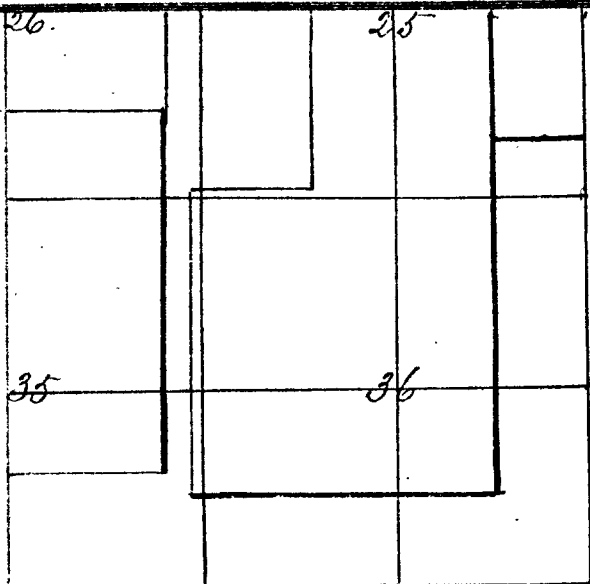

T. 25 S
R. 7 W.

Set a wagonthimble for SE^r corner of Wm Churchill^r don: by BT stumps, thence Var 19° 55' North 70.42 set a wagonthimble for NW corner of Will: Churchill^r don: thence East to river.

From SE corner of Wm Churchill^r don: West 6067 to SW corner of same as set by B.T.

From NE corner of B. Churchill^r don (East 30th set a tuyer iron) a rock set by me 10 years ago South to SE corner of same, a rock as set by me by the B.T.

Jos. Bryant April 19th 86.

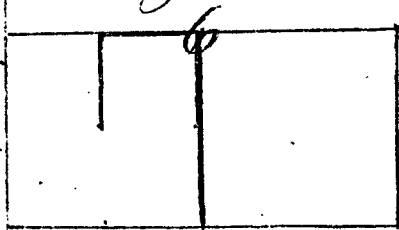

T. 24 S
R. 4 W.

From "4 set post between 6 & 7 Var. 19° E.
N 1° E 20.00 chns. set post a 5 rocks, from which
a bl. oak 24" in dia. bears N 58 3/4° W. 082 lks
N 1° E. 20.00 chns. set post a 4 rocks, from which
a bl. oak 42" in dia. bears N 85° W. 026 lks
N 89° 54' W. 20.00 chns, set post, from which a dbl. block 36" bears
S 70° W. 2000 chns set post, from which S 85° E 030 lks
a bl. oak 24" in dia bears N 56 1/4° E 030 lks.