

G. W. Garrol. March 24<sup>th</sup> 1885.

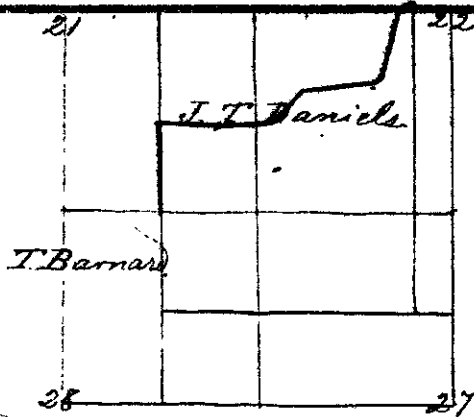

T. 25. S. R. 6 W.

From NE corner of T. Barnard's dom. Var. 19° 50' E

North 18.80 chns along Westbdy of J. T. Daniels's dom:  
 N 88 1/4° E 11.64 : prairie, creek field.  
 N 82 1/4° E 10.30 :  
 45 3/4 9.00 :  
 86 3/4 16.40 :  
 32 2.80 : down to house.  
 8 1/2 11.50 : to Co. road.  
 86 1/2 4.16 : to NE corner of J. T. Daniels's dom.

J. Shook. March 26<sup>th</sup> 1885.

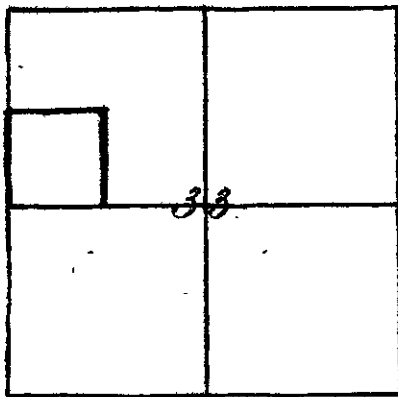

T. 24 S. R. 6 W.

From 1/4 post between 32 & 33 (a rock 12x6x5 as by BT) Var. 19° 55'

North 0.30-7.25 chns Hartley's field, descend.  
 20.00 chns. set rock 12x8x4 from which  
 a fir 48" in dia. bears S 67 1/4° E 052 the dist.  
 N 89° 55' E ascend 6.50. top of ascent  
 20.04 chns set post from which  
 a fir 12" in dia. bears N 80 1/4° E 36 the dist.  
 " " 20" " " S 54° E 58  
 South ascend 15.50. top of ascent.  
 20.00 chns. set post from which  
 a fir 12" in dia. bears N 79 1/2° E 54 the dist.  
 " " " " N 11° N. 26.